

## Quick Start Guide



Encore® TR-701 is a one-channel listen-only Talent Receiver that you can use with any Clear-Com partyline system. You can configure the beltpack using the DIP switches inside.

### Connectors, Controls and Indicators



### Connecting the Beltpack

1. Connect the TR-701 using standard microphone cable (up to a maximum of 500 feet) and the 3-pin XLR connectors on the base of the beltpack. For longer cable runs, see the *Encore Partyline Installation Manual*. The pin out is as below:

Pin	Function
1	Common
2	Power (+)
3	Audio

2. Adjust the sound level using the volume control.

### Operating the Beltpack

1. Connect the earphones to the TR-701. The earphone jack is a standard stereo mini jack with no connection to the ring contact. This provides monoaural audio output.

If the TR-701 is used with stereo earphones, only one earphone will function.

2. Use the volume control to adjust the volume of the audio. Turn the control clockwise to increase the volume, and counter clockwise to decrease the volume.

## Configuring the Beltpack

Use the DIP switches to configure the beltpack

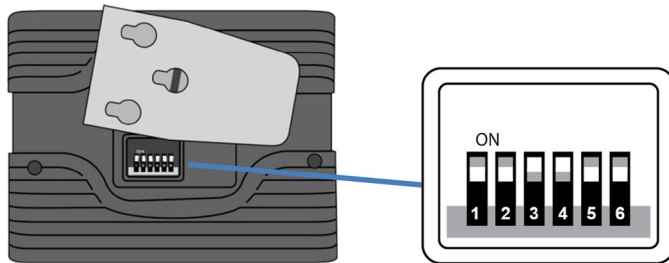
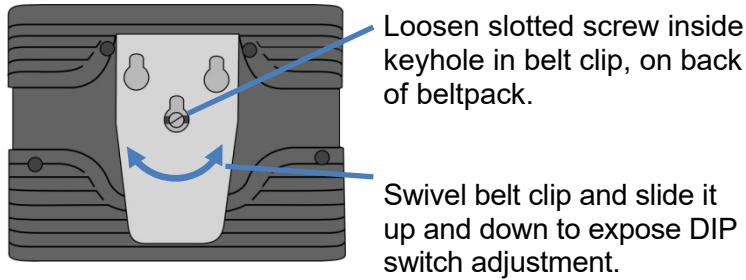

DIP Switch	Function
1	Not used
2	Headset Output Level <b>ON</b> = High <b>OFF</b> = Low
3	Min Volume <b>ON</b> = Silent at min level <b>OFF</b> = Not silent at min level
4	LEDs On/Off <b>ON</b> = LEDs normal operation <b>OFF</b> = All LEDs dark
5	Not used
6	Not used

## Beltpack Mount

The Beltpack Mount shipped with the TR-701 is a useful aid for stationary users who may place beltpacks on a work surface or tie them to a pole.

## Specifications

Specification	Value
Headphone type	Dynamic or Electret
Headphone impedance	30 Ohms or greater
Maximum output level	+20 dBm
Current required	12mA Max
Earphone connector	1/8 inch mini jack
Dimensions (H x D x W)	3.4 x 4.5 x 1.7 (inches) 86 x 114 x 43 (mm)
Weight	0.66 lb (299 g)